



**Australian Government**

**National Measurement  
Institute**

Bradfield Road, West Lindfield NSW 2070

# **Notification of Change**

## **Supplementary Certificate of Approval No S388**

### **Change No 2**

Issued by the Chief Metrologist under Regulation 60  
of the  
*National Measurement Regulations 1999*

The following changes are made to the approval documentation for the  
Teraoka Model Digi DI-80 Digital Indicator

submitted by           W W Wedderburn Pty Ltd  
                              now of 101 Williamson Road  
                              Ingleburn    NSW   2565.

- A.    In Supplementary Certificate of Approval No S388 dated 7 August 2003;
1.    The Condition of Approval referring to the review of the approval should be amended to read:
- “This approval becomes subject to review on 1 May **2016**, and then every 5 years thereafter.”
- Note: The review date was previously amended by Notification of Change No 1 dated 16 August 2006.
2.    The FILING ADVICE should be amended by adding the following:
- “Notification of Change No 1 dated 16 August 2006  
Notification of Change No 2 dated 4 August 2011”
- B.    In Supplementary Certificate of Approval No S388 and its Technical Schedule Variation No 1 both dated 7 August 2003, and in the Technical Schedule dated 16 May 2001, and in Notification of Change No 1 dated 16 August 2006, all references to the address of the submitter should be amended to read:
- “101 Williamson Road  
Ingleburn    NSW   2565”

- C. In Technical Schedule No S388 dated 16 May 2001;
1. In clause 1. **Description of Pattern** the 1<sup>st</sup> sentence should be amended to read, in part:  
“A Teraoka model Digi DI-80 **single interval** digital indicator ...”
  2. In TABLE 1, the reference to the value of Minimum Sensitivity should be amended to read:  
“1.33  $\mu\text{V}$ /scale interval”
  3. The TEST PROCEDURE should be replaced by the following:  
“Instruments shall be tested in accordance with any relevant tests specified in the national instrument test procedures.  
**Maximum Permissible Errors**  
The maximum permissible errors are specified in Schedule 1 of The *National Trade Measurement Regulations 2009*.”

Signed by a person authorised by the Chief Metrologist to exercise his powers under Regulation 60 of the *National Measurement Regulations 1999*.





## National Standards Commission

12 Lyonpark Road, North Ryde NSW

### Supplementary Certificate of Approval

**No S388**

Issued under Regulation 60  
of the  
National Measurement Regulations 1999

This is to certify that an approval for use for trade has been granted in respect of the

Teraoka Model Digi DI-80 Digital Indicator

submitted by W W Wedderburn Pty Ltd  
90 Parramatta Road  
Summer Hill NSW 2130.



**NOTE:** This Certificate relates to the suitability of the pattern of the instrument for use for trade only in respect of its metrological characteristics. This Certificate does not constitute or imply any guarantee of compliance by the manufacturer or any other person with any requirements regarding safety.

### CONDITIONS OF APPROVAL

This approval becomes subject to review on 1 May 2006, and then every 5 years thereafter.

Instruments purporting to comply with this approval shall be marked NSC No S388 and only by persons authorised by the submitter.

Instruments incorporating a digital indicator purporting to comply with this approval shall be marked NSC No S388 in addition to the approval number of the instrument.

It is the submitter's responsibility to ensure that all instruments marked with this approval number are constructed as described in the documentation lodged with the Commission and with the relevant Certificate of Approval and Technical Schedule. Failure to comply with this Condition may attract penalties under Section 19B of the National Measurement Act and may result in cancellation or withdrawal of the approval, in accordance with the Commission's Document NSC P 106.

The values of the performance criteria (maximum number of scale intervals etc.) applicable to an instrument incorporating the pattern approved herein shall be within the limits specified herein and in any approval documentation for the other components.

The Commission reserves the right to examine any instrument or digital indicator of an instrument purporting to comply with this approval.

Auxiliary devices used with this instrument shall comply with the requirements of General Supplementary Certificate No S1/0/A.

### DESCRIPTIVE ADVICE

**Pattern:** approved 17 April 2001

- A Teraoka model Digi DI-80 digital indicator.

Technical Schedule No S388 describes the pattern.

**Variants:** approved 24 June 2003

1. A Teraoka model Digi DI-80SS digital indicator.

Technical Schedule No S388 Variation No 1 describes variant 1.

### FILING ADVICE

Supplementary Certificate of Approval No S388 dated 16 May 2001 is superseded by this Certificate, and may be destroyed. The documentation for this approval now comprises:

Supplementary Certificate of Approval No S388 dated 7 August 2003

Technical Schedule No S388 dated 16 May 2001 (incl. Table 1 and Test Procedure)

Technical Schedule No S388 Variation No 1 dated 7 August 2003 (incl. Notification of Change)

Figures 1 and 2 dated 16 May 2001

Figure 3 dated 7 August 2003

Signed by a person authorised under Regulation 60 of the National Measurement Regulations 1999 to exercise the powers and functions of the Commission under this Regulation.



## TECHNICAL SCHEDULE No S388

**Pattern:** Teraoka Model Digi DI-80 Digital Indicator.

**Submittor:** W W Wedderburn Pty Ltd  
90 Parramatta Road  
Summer Hill NSW 2130.

### 1. Description of Pattern

A Teraoka model Digi DI-80 digital indicator (Figure 1 and Table 1) approved for use with up to 7500 verification scale intervals. Instruments may be fitted with output sockets for the connection of auxiliary and/or peripheral devices, and also either with or without the integral printer.

#### 1.1 Zero

Zero is automatically corrected to within  $\pm 0.25e$  whenever the instrument comes to rest within  $0.5e$  of zero.

The instrument has a semi-automatic zero-setting device with a nominal range of not more than 4% of the maximum capacity of the instrument.

The instrument has an initial zero-setting device with a nominal range of not more than 20% of the maximum capacity of the instrument.

#### 1.2 Tare

A semi-automatic and/or a non-automatic keyboard-entered subtractive pre-set taring device, each having a capacity of up to the maximum capacity of the instrument, may be fitted.

#### 1.3 Display Check

A display check is initiated whenever power is applied.

#### 1.4 Additional Facilities

Instruments may be fitted with a set point facility.

Indications other than the indications of measured mass (i.e. gross, tare, net) displayed either on the indicator or on an auxiliary or peripheral device, are not for trade use.

#### 1.5 Sealing Provision

Provision is made for the access to the calibration adjustment at the rear of the indicator to be sealed by means of sealing screws or destructible label (Figure 2).

#### 1.6 Verification/Certification Provision

Provision is made for the application of a verification/certification mark.

## 1.7 Markings

Instruments carry the following markings:

Manufacturer's mark, or name written in full	Teraoka, Singapore
Name or mark of manufacturer's agent	W W Wedderburn Pty Ltd
Indication of accuracy class	Ⓜ
Maximum capacity	Max ..... kg *
Minimum capacity	Min ..... kg *
Verification scale interval	e = ..... kg *
Serial number of the instrument	.....
Pattern approval mark for the indicator	NSC No S388

\* These markings are also shown near the display of the result if they are not already located there.

In addition, instruments not greater than 100 kg capacity shall carry a notice stating NOT TO BE USED FOR TRADING DIRECT WITH THE PUBLIC, or similar wording.

TABLE 1 — Specifications

Maximum number of verification scale intervals	7500
Minimum sensitivity	1.33 $\mu$ V/scale interval
Excitation voltage	10 V DC
Maximum excitation current	233 mA

## TEST PROCEDURE

~~Instruments should be tested in conjunction with any tests specified in the approval documentation for the instrument to which the pattern is connected, as appropriate, and in accordance with any relevant tests specified in the Uniform Test Procedures.~~

### ~~Maximum Permissible Errors at Verification/Certification~~

~~The maximum permissible errors for increasing and decreasing loads on initial verification/certification for loads,  $m$ , expressed in verification scale intervals,  $e$ , are:~~

- ~~$\pm 0.5e$  for loads  $0 \leq m \leq 500$ ;~~
- ~~$\pm 1.0e$  for loads  $500 < m \leq 2\,000$ ; and~~
- ~~$\pm 1.5e$  for loads  $2\,000 < m \leq 10\,000$ .~~

TECHNICAL SCHEDULE No S388  
VARIATION No 1

**Pattern:** Teraoka Model Digi DI-80 Digital Indicator.

**Submittor:** W W Wedderburn Pty Ltd  
90 Parramatta Road  
Summer Hill NSW 2130.



**1. Description of Variant 1**

A Teraoka model Digi DI-80SS digital indicator (Figure 3) which has a stainless steel housing.

Power supply may be either:

- 240 V AC;
- an external 12 V AC/DC mains adaptor; or
- an internal rechargeable battery.

Note: The AC/DC mains adaptor supplied was a Wedderburn model 12VDC2A power supply (Output 12 V DC, 2 A). The submittor should be consulted regarding the acceptability of alternatives.

NOTIFICATION OF CHANGE

In Technical Schedule No S388 dated 16 May 2001, the following should be added to clause **1. Description of Pattern:**

“Instruments are powered by a Wedderburn model 12VDC2A power supply (Output 12 V DC, 2 A). The submittor should be consulted regarding the acceptability of alternatives.”



**Australian Government**  
**National Measurement  
Institute**

Bradfield Road, West Lindfield NSW 2070

**Notification of Change**  
**Supplementary Certificate of Approval No S388**  
**Change No 1**

Issued by the Chief Metrologist under Regulation 60  
of the  
*National Measurement Regulations 1999*

The following change is made to the approval documentation for the

Teraoka Model Digi DI-80 Digital Indicator

submitted by W W Wedderburn Pty Ltd  
90 Parramatta Road  
SUMMER HILL NSW 2130.

In Supplementary Certificate of Approval No S388 dated 7 August 2003, the Condition of Approval referring to the review of the approval should be amended to read:

“This approval becomes subject to review on 1 May 2011, and then every 5 years thereafter.”

Signed by a person authorised by the Chief Metrologist to exercise his powers under Regulation 60 of the *National Measurement Regulations 1999*.

A handwritten signature in black ink, appearing to be 'J. G. T.', written in a cursive style.

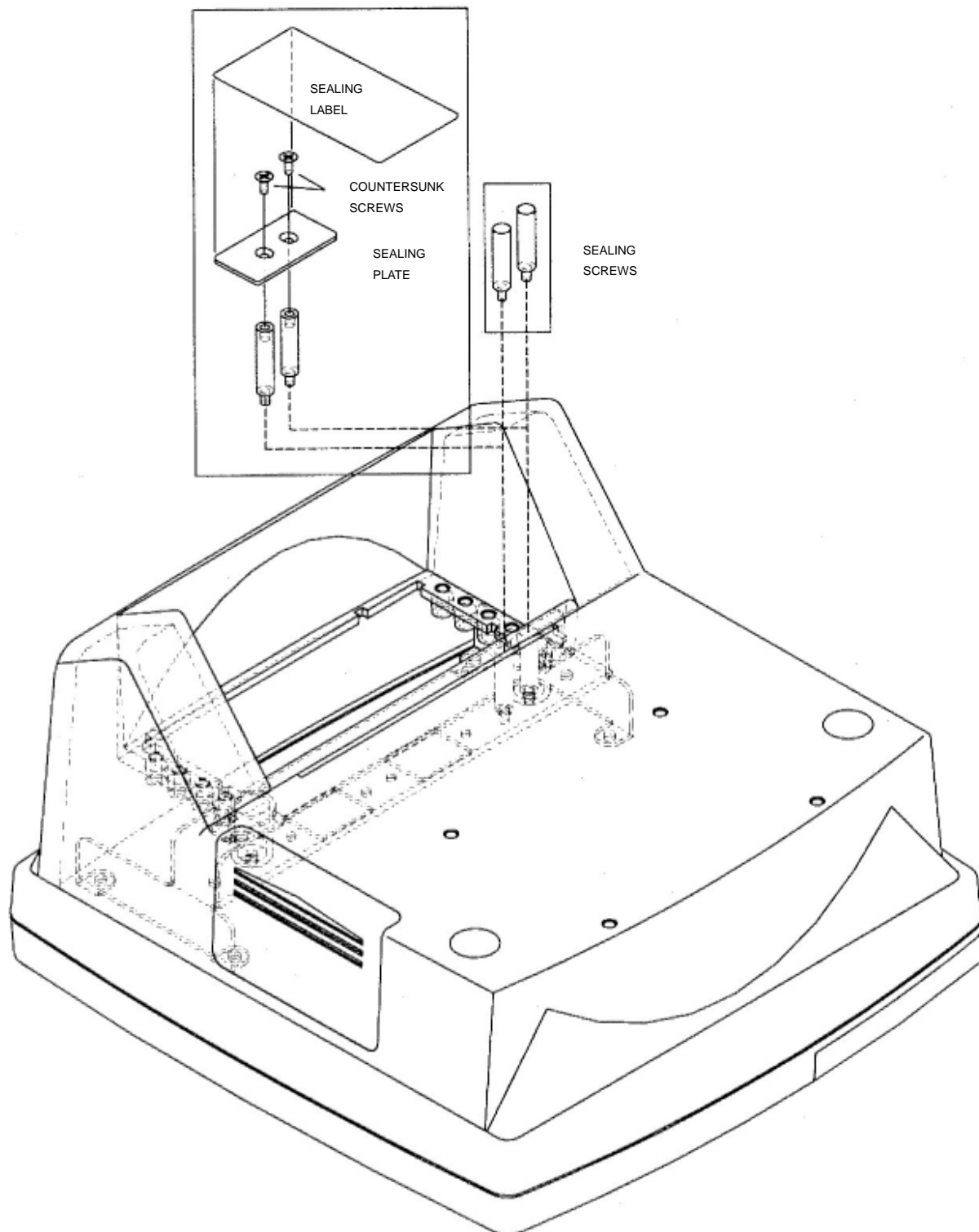

FIGURE S388 - 1



Teraoka Model Digi DI-80 Digital Indicator

FIGURE S388 - 2



Showing Sealing

FIGURE S388 – 3



Teraoka Model Digi DI-80SS Digital Indicator