



Australian Government

**National Measurement
Institute**

12 Lyonpark Road, North Ryde NSW 2113

**Cancellation
Certificate of
Approval No 6/18/32**

Issued by the Chief Metrologist under Regulation 60
of the
National Measurement Regulations 1999

This is to certify that the approval for use for trade granted in Approval No 6/18/32 in respect of the

Wedderburn Model WS-1200M Overhead-track Weighing Instrument

submitted by W W Wedderburn Pty Ltd
90 Parramatta Road
SUMMER HILL NSW 2130

has been cancelled in respect of new instruments as from 1 April 2005.

Signed by a person authorised by the Chief Metrologist
to exercise his powers under Regulation 60 of the
National Measurement Regulations 1999.

A handwritten signature in black ink, appearing to be 'J. H. T.', is written over the signature line.



National Standards Commission

Certificate of Approval

No 6/18/32

Issued under Regulation 9
of the
National Measurement (Patterns of Measuring Instruments) Regulations

This is to certify that an approval for use for trade has been granted in respect of the

Wedderburn Model WS-1200M Overhead-track Weighing Instrument

submitted by W W Wedderburn Pty Ltd
90 Parramatta Road
Summer Hill NSW 2130.

NOTE: This Certificate relates to the suitability of the pattern of the instrument for use for trade only in respect of its metrological characteristics. This Certificate does not constitute or imply any guarantee of compliance by the manufacturer or any other person with any requirements regarding safety.

CONDITIONS OF APPROVAL

This approval becomes subject to review on 1 January 2004, and then every 5 years thereafter.

Instruments purporting to comply with this approval shall be marked NSC No 6/18/32 and only by persons authorised by the submitter.

It is the submitter's responsibility to ensure that all instruments marked with this approval number are constructed as described in the documentation lodged with the Commission and with the relevant Certificate of Approval and Technical Schedule. Failure to comply with this Condition may attract penalties under Section 19B of the National Measurement Act and may result in cancellation or withdrawal of the approval, in accordance with the Commission's Document 106.

The Commission reserves the right to examine any instrument or component of an instrument purporting to comply with this approval.

Auxiliary devices used with this instrument shall comply with the requirements of General Supplementary Certificate No S1/0/A.

Alternative Commission-approved indicators may be used in which case instruments shall comply with General Certificate No 6B/0.

DESCRIPTIVE ADVICE

Pattern: approved 8 December 1998

- A Wedderburn model WS-1200M overhead-track weighing instrument of 300 kg maximum capacity.

Variant: approved 8 December 1998

1. A model WS-1200M of 600 kg maximum capacity.

Technical Schedule No 6/18/32 describes the pattern and variant 1.

FILING ADVICE

The documentation for this approval comprises:

Certificate of Approval No 6/18/32 dated 30 March 1999
Technical Schedule No 6/18/32 dated 30 March 1999 (incl. Test Procedure)
Notification of Change No 1 dated 4 April 2000
Notification of Change No 2 dated 28 April 2000
Figures 1 and 2 dated 30 March 1999

Signed and sealed by a person authorised under Regulation 9 of the National Measurement (Patterns of Instruments) Regulations to exercise the powers and functions of the Commission under this Regulation.

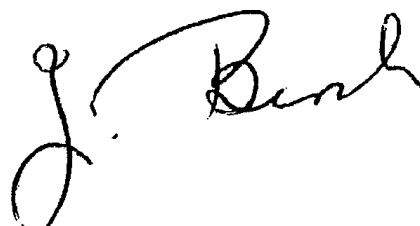

TECHNICAL SCHEDULE No 6/18/32

Pattern: Wedderburn Model WS-1200M Overhead-track Weighing Instrument.

Submittor: W W Wedderburn Pty Ltd
90 Parramatta Road
Summer Hill NSW 2130.

1. Description of Pattern

A Wedderburn model WS-1200M overhead-track weighing instrument of 300 kg maximum capacity with a verification scale interval of 0.1 kg.

1.1 Trackwork

The model WS-1200M (Figure 1) has the weigh-rail of up to 1200 mm in length suspended from two load cells.

1.2 Load Cells

Two Teraoka model MC300 load cells of 300 kg capacity are used and mounted as shown in Figure 1. Note that only this make, model and capacity of load cells shall be used.

For the purposes of calculations required by NSC General Certificate No 6B/0 when an alternative indicator is used, the following parameters may be used for the model MC300 load cell:

Maximum capacity	300 kg
Input impedance	430 ohms
Sensitivity	1 mV/V
Minimum value of verification scale interval	0.14 kg

1.3 Indicator

A Digi model DI-170 digital indicator (Figure 2) is used. The indicator is also described in the documentation of NSC approval No S357.

1.4 Markings

Instruments carry the following markings, in the form shown at right:

Manufacturer's mark, or name written in full	Wedderburn
Indication of accuracy class	Ⓜ
Maximum capacity	Max kg *
Minimum capacity	Min kg *
Verification scale interval	e = kg *
Serial number of the instrument
Serial numbers of the load cells (#)
Pattern approval mark for the instrument	NSC No 6/18/32
Pattern approval mark for the indicator	NSC No S

* These markings shall also be shown near the display of the result if they are not already located there.

Alternatively, these may be marked adjacent to the verification mark.

1.5 Sealing Provision

Provision is made for the calibration adjustments to be sealed by means of the method described in the approval documentation for the indicator.

1.6 Verification/Certification Provision

Provision is made for the application of a verification/certification mark.

2. Description of Variant 1

A model WS-1200M overhead-track weighing instrument of 600 kg maximum capacity with a verification scale interval of 0.2 kg.

2.1 Trackwork

The model WS-1200M has the weigh-rail of up to 1200 mm in length suspended from two load cells.

2.2 Load Cells

Two Teraoka model MD600 load cells of 600 kg capacity are used and mounted as shown in Figure 3. Note that only this make, model and capacity of load cells shall be used.

For the purposes of calculations required by NSC General Certificate No 6B/0 when an alternative indicator is used, the following parameters may be used for the model MC600 load cell:

Maximum capacity	600 kg
Input impedance	430 ohms
Sensitivity	1 mV/V
Minimum value of verification scale interval	0.14 kg

TEST PROCEDURE

Instruments should be tested in conjunction with any tests specified in the approval documentation for the indicator used, and in accordance with any relevant tests specified in the Inspector's Handbook.

Maximum Permissible Errors at Verification/Certification

The maximum permissible errors for increasing and decreasing loads on initial verification/certification for loads, m , expressed in verification scale intervals, e , are:

- $\pm 0.5 e$ for loads $0 \leq m \leq 500$;
- $\pm 1.0 e$ for loads $500 < m \leq 2\,000$; and
- $\pm 1.5 e$ for loads $2\,000 < m \leq 10\,000$.

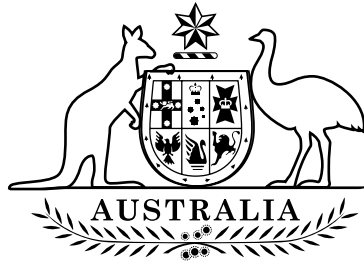

National Standards Commission

Notification of Change

Certificate of Approval No 6/18/32

Change No 1

The following changes are made to the approval documentation for the

Wedderburn Model WS-1200M Overhead-track Weighing Instrument

submitted by W W Wedderburn Pty Ltd
90 Parramatta Road
Summer Hill NSW 2130.

- A. In Technical Schedule No 6/18/32 dated 30 March 1999, pages 1 and 2 are replaced by the attached pages 1 to 3 wherein references to load cell parameters have been added to both clause **1.2 Load Cells** and clause **2.2 Load Cells**.
- B. In Certificate of Approval No 6/18/32 dated 30 March 1999, the FILING ADVICE should be amended by adding a reference to this Notification of Change as follows:

“Notification of Change No 1 dated 4 April 2000”

Signed and sealed by a person authorised under Regulation 63 of the National Measurement Regulations 1999 to exercise the powers and functions of the Commission under this Regulation.



National Standards Commission

Notification of Change

Certificate of Approval No 6/18/32

Change No 2

The following changes are made to the approval documentation for the
Wedderburn Model WS-1200M Overhead-track Weighing Instrument

submitted by W W Wedderburn Pty Ltd
90 Parramatta Road
Summer Hill NSW 2130.

- A. In Technical Schedule No 6/18/32 dated 4 April 2000 (issued as part of Notification of Change No 1 dated 4 April 2000), the *Minimum value of verification scale interval* for the model MC300 load cells, as given in clause **1.2 Load Cells** should be amended to read "0.07 kg".
- B. In Certificate of Approval No 6/18/32 dated 30 March 1999, the FILING ADVICE should be amended by adding a reference to this Notification of Change as follows:

"Notification of Change No 2 dated 28 April 2000"

Signed and sealed by a person authorised under Regulation 63 of the National Measurement Regulations 1999 to exercise the powers and functions of the Commission under this Regulation.

FIGURE 6/18/32 - 1

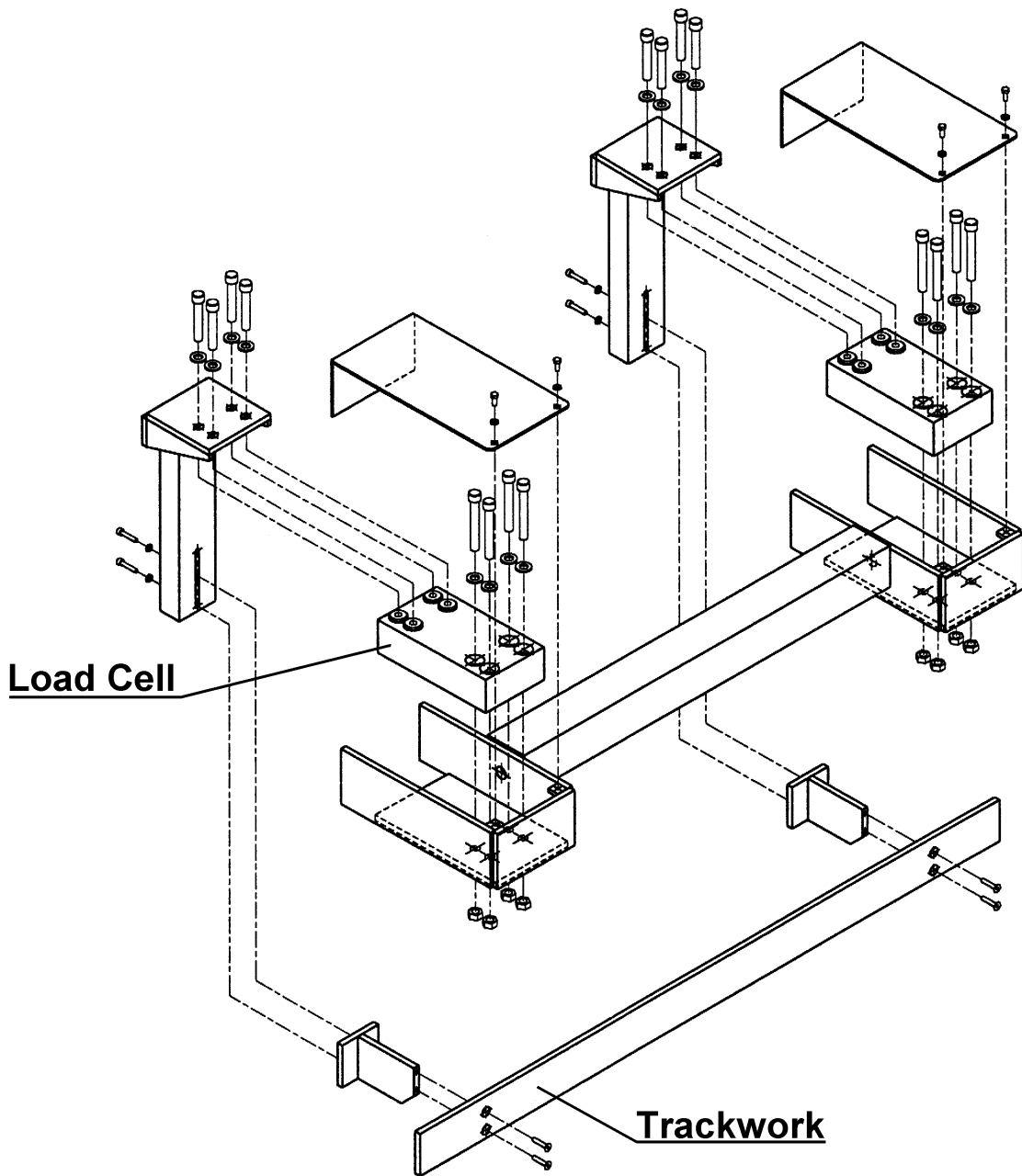

Wedderburn model WS-1200M Trackwork

6/18/32
30 March 1999

FIGURE 6/18/32 - 2



Digi Model DI-170 Digital Indicator