

National Standards Commission



Cancellation Certificate of Approval No 5/6S/1B

This is to certify that an approval for use for trade has been granted in respect of the

Autobar Model 880 Remote-storage Bulk Liquor Dispenser

submitted by IMI Cornelius Australia Pty Limited
Unit 6/165 Rookwood Road
Yagoona NSW 2199

has been cancelled in respect of new instruments as from 31 December 1997.

Instruments which were verified/certified before that date may, with the concurrence of the relevant verifying authority, be submitted for reverification.

Signed and sealed by a person authorised under Regulation 9 of the National Measurement (Patterns of Measuring Instruments) Regulations to exercise the powers and functions of the Commission under this Regulation.

A handwritten signature in black ink, appearing to read 'J. Birch', written in a cursive style.

National Standards Commission



Certificate of Approval

No 5/6S/1B

Issued under Regulation 9
of the
National Measurement (Patterns of Measuring Instruments) Regulations

This is to certify that an approval for use for trade has been granted in respect of the

Autobar Model 880 Remote-storage Bulk Liquor Dispenser

submitted by IMI Cornelius Australia Pty Limited
Unit 6/165 Rockwood Road
Yagoona NSW 2199.

NOTE: This Certificate relates to the suitability of the pattern of the instrument for use for trade only in respect of its metrological characteristics. This Certificate does not constitute or imply any guarantee of compliance by the manufacturer or any other person with any requirements regarding safety.

CONDITIONS OF APPROVAL

This approval became subject to review on 1 October 1996, and then every 5 years thereafter.

Instruments purporting to comply with this approval shall be marked NSC No 5/6S/1B and only by persons authorised by the submittor.

The Commission reserves the right to examine any instrument or component of an instrument purporting to comply with this approval.

It is the submittor's responsibility to ensure that all instruments marked with this approval number are constructed as described in the documentation lodged with the Commission and with the relevant Certificate of Approval and Technical Schedule. Failure to comply with this Condition may attract penalties under Section 19B of the National Measurement Act and may result in cancellation or withdrawal of the approval, in accordance with the Commission's Document 106.

DESCRIPTIVE ADVICE

Pattern: approved 10 September 1991

- An Autobar model 880 remote-storage liquor dispenser approved to deliver brandy (including cognac and armagnac), gin, rum, vodka or whisky (whiskey).

Technical Schedule No 5/6S/1B describes the pattern.

Variants: approved 30 April 1996

1. With an alternative internal operating switch.
2. With a modified printed circuit board.
3. With sealable dispensing head covers.
4. With a hand-held dispenser.

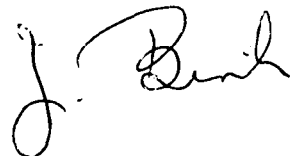
Technical Schedule No 5/6S/1B Variation No 1 describes variants 1 to 4.

FILING ADVICE

Certificate of Approval No 5/6S/1B dated 2 March 1992 is superseded by this Certificate and may be destroyed. The documentation for this approval now comprises:

Certificate of Approval No 5/6S/1B dated 18 November 1996
Technical Schedule No 5/6S/1B dated 2 March 1992 (incl. Test Procedure)
Technical Schedule No 5/6S/1B Variation No 1 dated 18 November 1996 (incl. Notification of Change)
Figures 1 to 4 dated 2 March 1992
Figures 5 to 8 dated 18 November 1996

Signed and sealed by a person authorised under Regulation 9 of the National Measurement (Patterns of Measuring Instruments) Regulations to exercise the powers and functions of the Commission under this Regulation.





National Standards Commission

TECHNICAL SCHEDULE No 5/6S/1B

Pattern: Autobar Model 880 Remote Storage Bulk Liquor Dispenser.

Submittor: CIG Hospitality Equipment
53 - 55 Lorraine Street
Peakhurst NSW 2210.

1. Description of Pattern

An Autobar model 880 remote storage liquor dispenser approved to deliver brandy (including cognac and armagnac), gin, rum, vodka or whisky (whiskey).

1.1 The System

Instruments may be as shown in Figure 1 or in alternative housings.

The pattern incorporates up to 6 electrically-controlled, pressurised piston-displacement type, lever-operated dispensing heads (Figure 2). Each dispensing head (Figure 3) may deliver either 15 mL or 30 mL quantities only, and consists of:

- a spring-driven piston-displacement type metering pump with two micro-switch controlled, solenoid-operated valves (Figure 4); and
- a bulk liquor supply tank, pressurised from a gas supply which maintains a pressure of between 275 kPa and 415 kPa.

1.2 Operation

A full quantity of liquor is measured when the operating lever is pressed. A delivery once started cannot be stopped by the operator and the operating lever is rendered inoperative throughout this cycle. A delivery having been made, a further delivery cannot be started until the pump is refilled with liquor.

At the commencement of the delivery cycle, which is initiated by pressing the operating lever, the solenoid-operated valve in the dispensing head is opened, allowing the spring-driven pump piston to displace the liquor in the pump. At the completion of the stroke, the valve in the dispensing head is closed, and a similar valve at the top of the piston is opened. Liquor from the pressurised supply tank then refills the pump, compressing the spring-loaded piston ready for the next delivery.

The stroke (displacement) of the piston determines the size of the pour and is controlled by the two micro-switches.

1.3 Markings

Instruments are marked with the following, together in a prominent position:

Manufacturer's name or mark
Serial number of the instrument
NSC approval number

NSC No 5/6S/1B

In addition, each metering pump and corresponding dispensing head is marked with the following information clearly visible to the vendor and purchaser.

The pour size for which it is verified, viz. "15 mL" or "30 mL";
The type of liquor to be dispensed.

1.4 Sealing and Verification/Certification Provision

The calibration devices of each metering pump are sealed.

Provision is made for a verification/certification mark to be applied.

TEST PROCEDURE

Instruments should be tested in accordance with any relevant tests specified in the Inspector's Handbook.

Maximum Permissible Errors at Verification/Certification

The maximum permissible errors applied during a verification/certification test are:

± 0.6 mL for deliveries of 15 mL; and
 ± 1.0 mL for deliveries of 30 mL.

If water is used for testing this measure and the measuring chamber fails to drain completely, it will be necessary to add approximately one part alcohol to 3 parts water to reduce the surface tension of the test liquid. Methylated spirits can be used as the source of alcohol.

Whilst a delivery is being made, depress the operating lever a second time; no further delivery should take place until the initial delivery is completed and the lever is released and re-pressed.



National Standards Commission

TECHNICAL SCHEDULE No 5/6S/1B

VARIATION No 1

Pattern: Autobar Model 880 Remote Storage Bulk Liquor Dispenser.

Submittor: IMI Cornelius Australia Pty Limited
Unit 6/165 Rockwood Road
Yagoona NSW 2199.

1. Description of Variants

1.1 Variant 1

With an alternative electrical switch located in each dispensing head and activated by the operating lever. Figure 5 shows a dispenser arrangement that includes an additional bank of dispensers that are only used for non-alcoholic beverages.

1.2 Variant 2

With a modified printed circuit board located in the enclosure also containing the metering pumps (Figure 2). The enclosure may also be that shown in Figure 6.

1.3 Variant 3

With the dispensing head covers secured by a sealable screw.

1.4 Variant 4

With a hand-held multi-outlet dispenser (Figure 7).

The indicator for this variant (Figures 7 and 8) is in a position clearly visible to the purchaser and shows the pour size and the type of liquor being dispensed, as indicated by an LED being illuminated.

NOTIFICATION OF CHANGE

The following changes should be made to Technical Schedule No 5/6S/1B dated 2 March 1992:

1. In clause **1.1 The System**:
 - (a) amend the reference to "(Figure 2)" to read "(Figure 1)";
 - (b) delete the reference to "(Figure 3)"; and
 - (c) amend the reference to "(Figure 4)" to read "(Figures 2 to 4)".

2. Amend the captions on the illustrations as follows:
 - (a) FIGURE 5/6S/1B - 2, to read "Showing Metering Pumps and Printed Circuit Board"
 - (b) FIGURE 5/6S/1B - 3, to read "Metering Pump With Covers Removed"

National Standards Commission



NOTIFICATION OF CHANGE
CERTIFICATE OF APPROVAL No 5/6S/1B
CHANGE No 1

The following change is made to the approval documentation for the

Autobar Model 880 Remote-storage Bulk Liquor Dispenser

submitted by CIG Hospitality Equipment
53 - 55 Lorraine Street
Peakhurst NSW 2210.

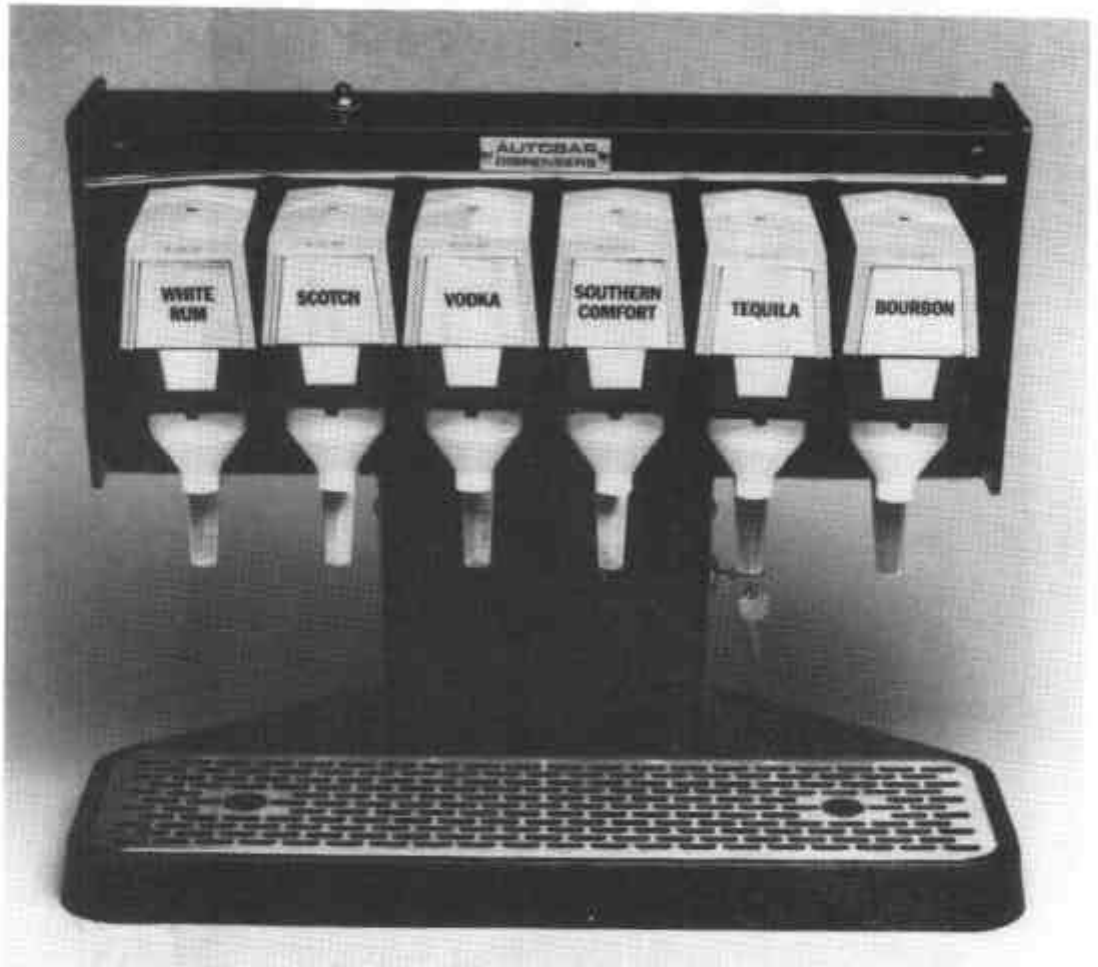
In Certificate of Approval No 5/6S/1B and its Technical Schedule both dated 2/3/92, the name of the submitter should be changed to read:

"IMI Cornelius Australia Pty Limited"

Signed and sealed by a person authorised under Regulation 9 of the National Measurement (Patterns of Measuring Instruments) Regulations to exercise the powers and functions of the Commission under this Regulation.

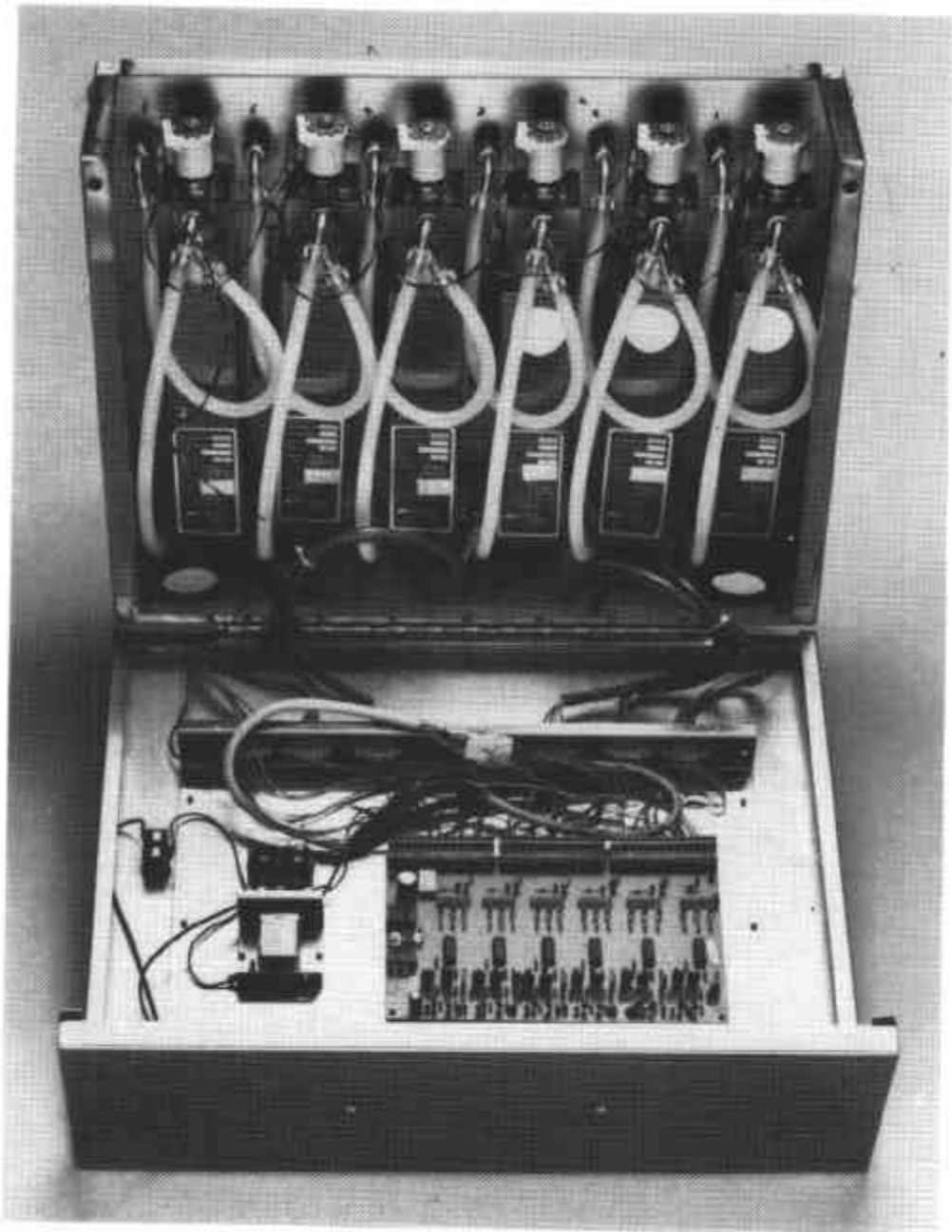


FIGURE 5/6S/1B - 1



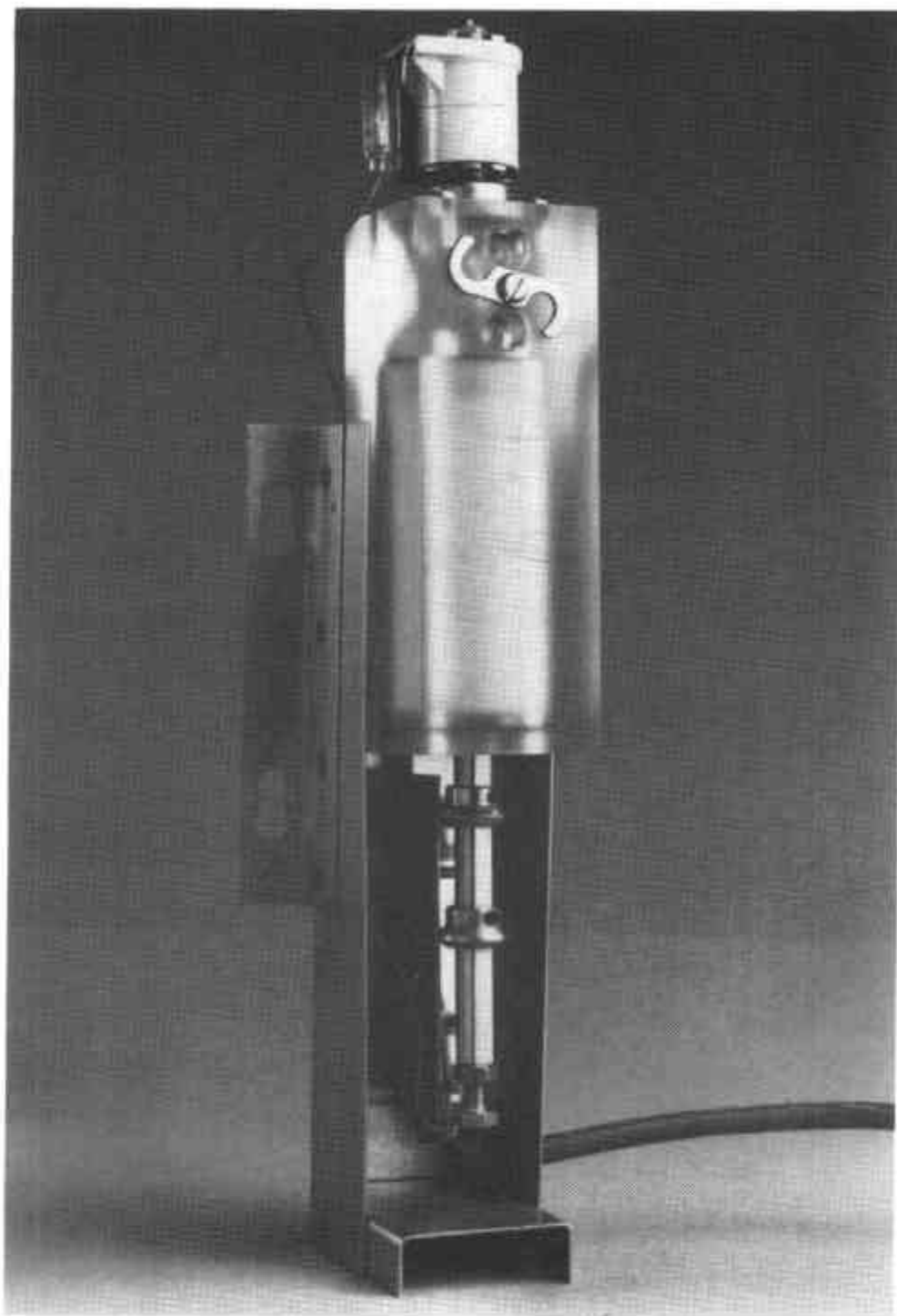
Autobar Model 880 Liquor Dispenser

FIGURE 5/6S/1B - 2



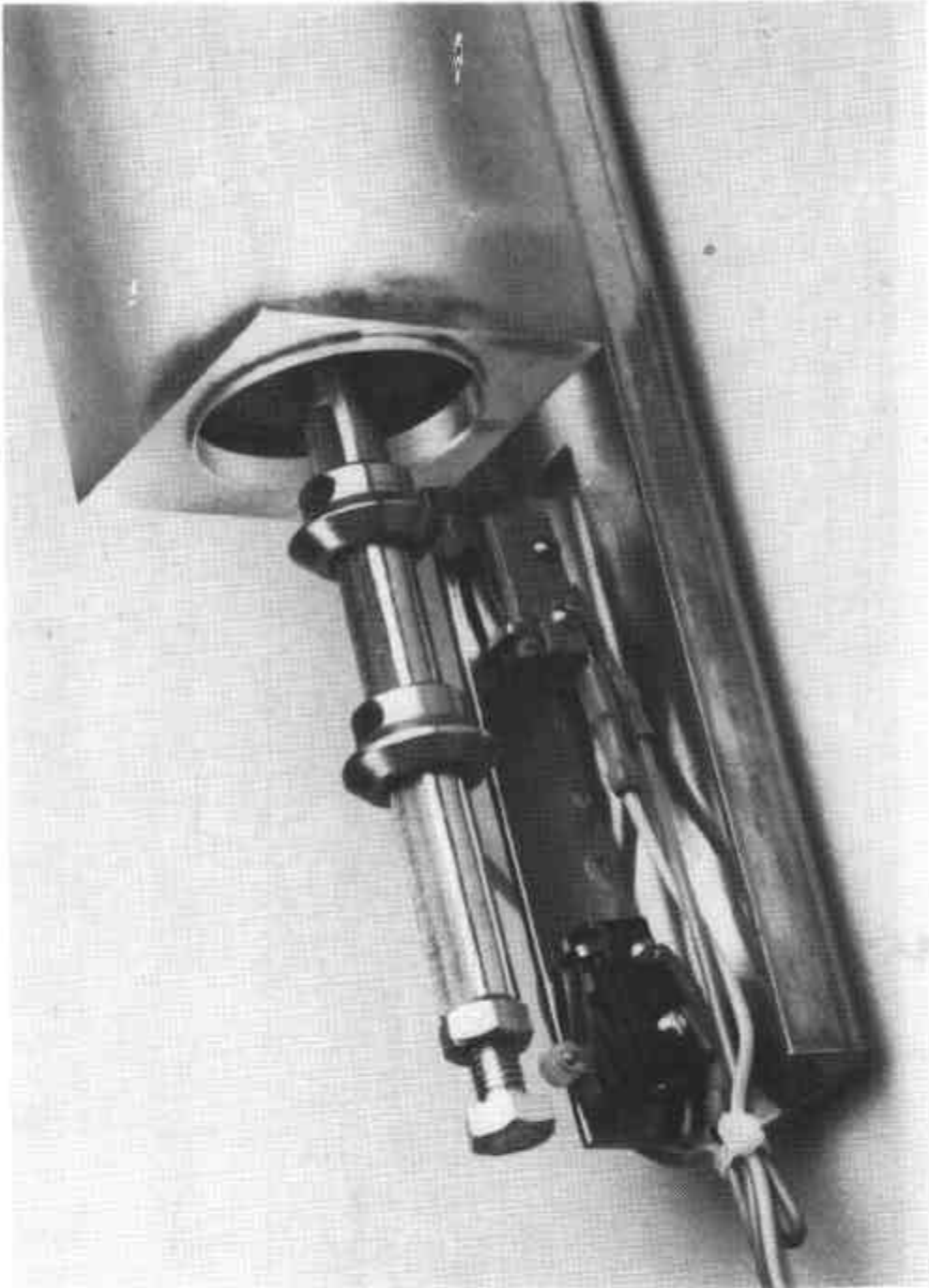
Showing Dispensing Heads

FIGURE 5/6S/1B - 3



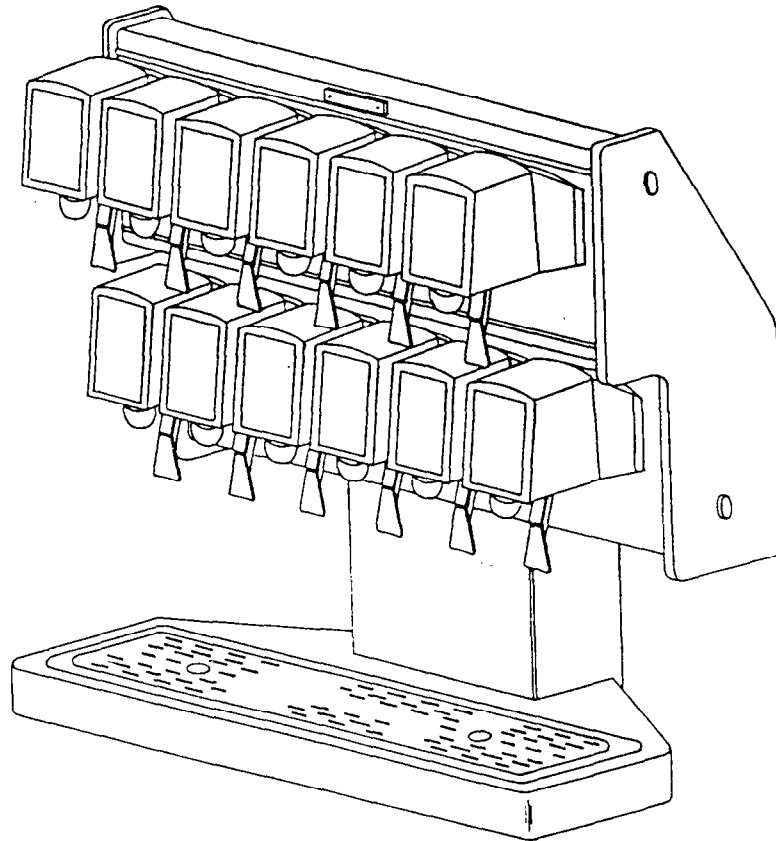
Dispensing Head With Covers Removed

FIGURE 5/6S/1B - 4



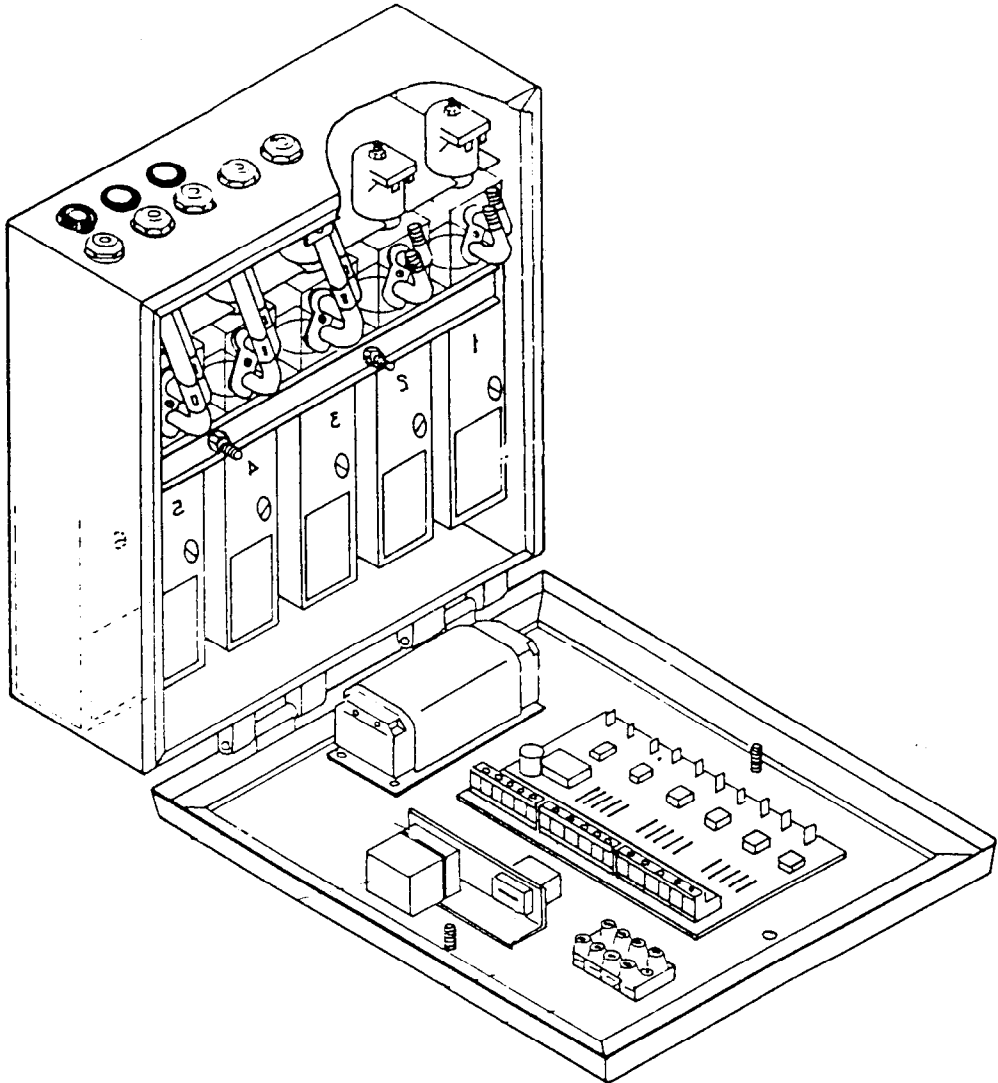
Showing Micro-switches

FIGURE 5/6S/1B - 5



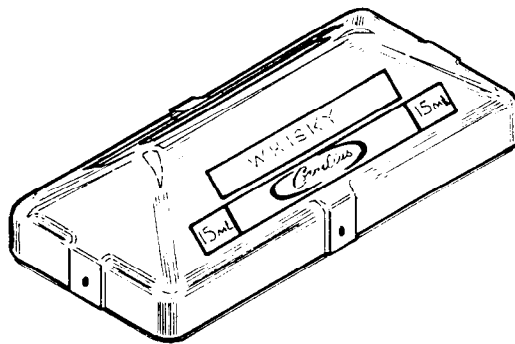
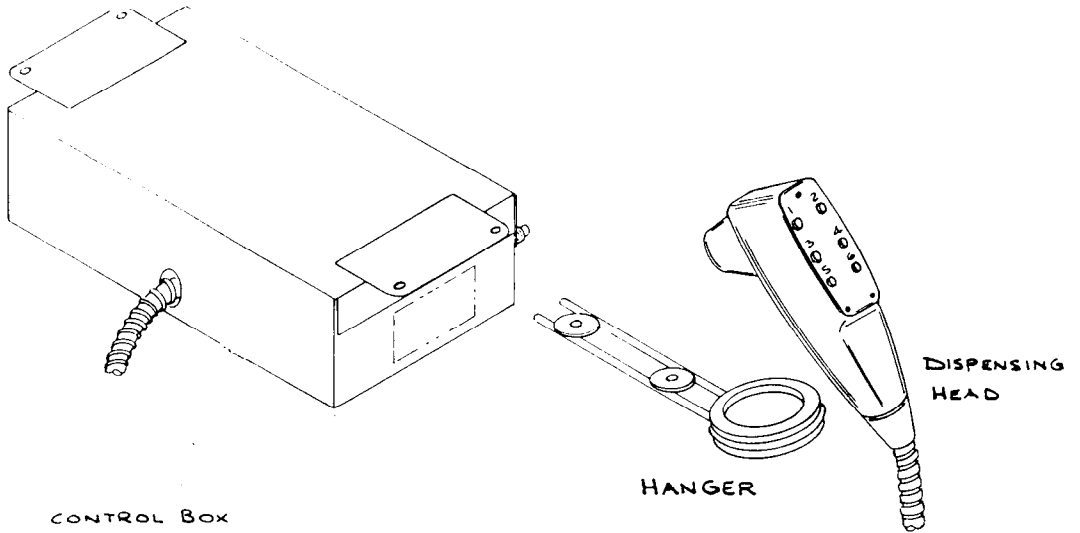
Typical Dispenser Including Non-alcoholic Dispensing Heads

FIGURE 5/6S/1B - 6



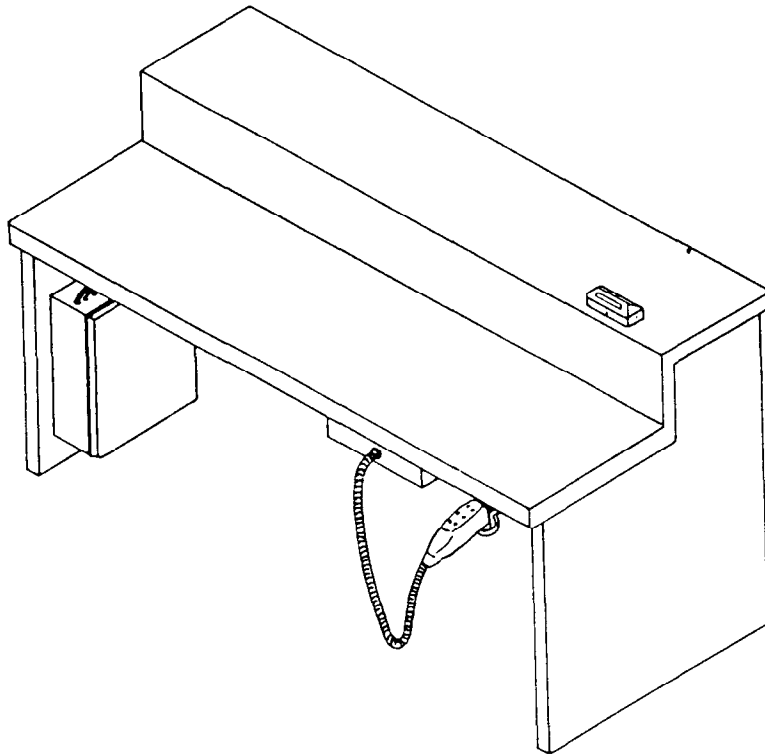
Alternative Enclosure for Metering Pumps

FIGURE 5/6S/1B - 7



Hand-held Dispensing System

FIGURE 5/6S/1B - 8



Typical Hand-held Dispenser Arrangement